

TANK ASSEMBLY INSTRUCTIONS: CLASSIC, BDF & SVP PUMP SERIES

• Tank Accessories

- ✓ 2 mounting bracket screws
- ✓ 2 grommets (1/4")
- ✓ 1 grommet (3/8")

• Tanks for BDF or SVP pump also includes

- ✓ 1 motor base
- ✓ 1 motor base screw (self-tapping)

DRILL PROPER HOLE SIZES

1/4" grommet	3/8" drill bit
3/8" grommet	1/2" drill bit



1. Mounting Bracket

- Attach mounting bracket screw to the lowest hole in the tank and leave it loose enough to slide the mounting bracket under the screw head. Then slide bracket under the screw head (see back, **A**).
- Attach the 2nd mounting bracket screw to secure the top of the mounting bracket and tighten both screws (10-15 inch lbs). Do not slide pump into bracket at this time.

2. Grommets

- Measure and mark the two locations to drill the holes (see back, **B & C**).
- Drill proper hole sizes (see chart at left).
- Install applicable grommets into holes. **B & C** (see back) show the recommended hole locations which may vary based on the application or user's requirements.

Caution: Failure to clean all debris from inside the tank before use will result in poor pump performance.

3. Suction Line

- You'll need the following accessories that were shipped with the Stenner pump:
 - ✓ 20' suction/discharge tubing
 - ✓ 1 connecting nut
 - ✓ 1 ferrule
 - ✓ 1 ceramic weight w/clip
- Insert clip into ceramic weight and set aside.
- Insert suction tubing through the grommet (on the side of tank) until it is 2" - 3" from the bottom of the tank (see back, **D**).
- Remove fill cap.
- Reach inside tank and insert tubing into (pre-assembled) weight w/clip until tubing is 1" from the end of the weight and place into the tank (see back, **E**).

- Adjust tubing to maintain weight 2" - 3" from the tank bottom.

Do not allow the weight to rest on the bottom of the tank.

- Trim the remaining suction tubing (that is extending out of the tank) to approximately 9" to connect (later in the installation) to the suction side of the pump (see back, **F**).
- Cut a separate section of the tubing approximately 6" long and insert through the spill recovery grommet (see back, **G**).

4. Pump Head Cover Preparation for Spill Recovery

- Remove the two pump head cover screws and remove pump head cover.
- Punch out the hole plug using a 7/32" punch (see back, **H**).
- Re-fasten pump head cover and finger tighten screws (7-10 inch lbs).

Cover screws are self-tapping and should be turned counter clockwise until seated. Overtightening of the screws can result in a stripped screw boss and/or a crack in the pump head housing.

5. Feed Pump Attachment and Connections

- Slide feed pump into mounting bracket (see back, **I**).
- Insert the end of the tubing extending out from the spill recovery grommet into the pump head cover but not inside the pump head.
- Connect suction tubing to suction side of the pump (labeled "IN" on pump head cover) with connecting nut and ferrule (see back, **J**).
- **Connection should be "finger tight" only. Do not use pliers, thread tape or pipe dope.**
- Complete the installation with the instructions found in the pump manual.

Reliable Chemical Feed Pumps Since 1957



3174 DeSalvo Road
Jacksonville, Florida 32246
Phone 904-641-1666
US Toll Free 800-683-2378
Fax 904-642-1012

www.stenner.com
sales@stenner.com
Hours of Operation (EST)
Mon - Thu. 7AM - 5PM
Friday 7AM - Noon

Stenner & Co., Inc
All Rights Reserved

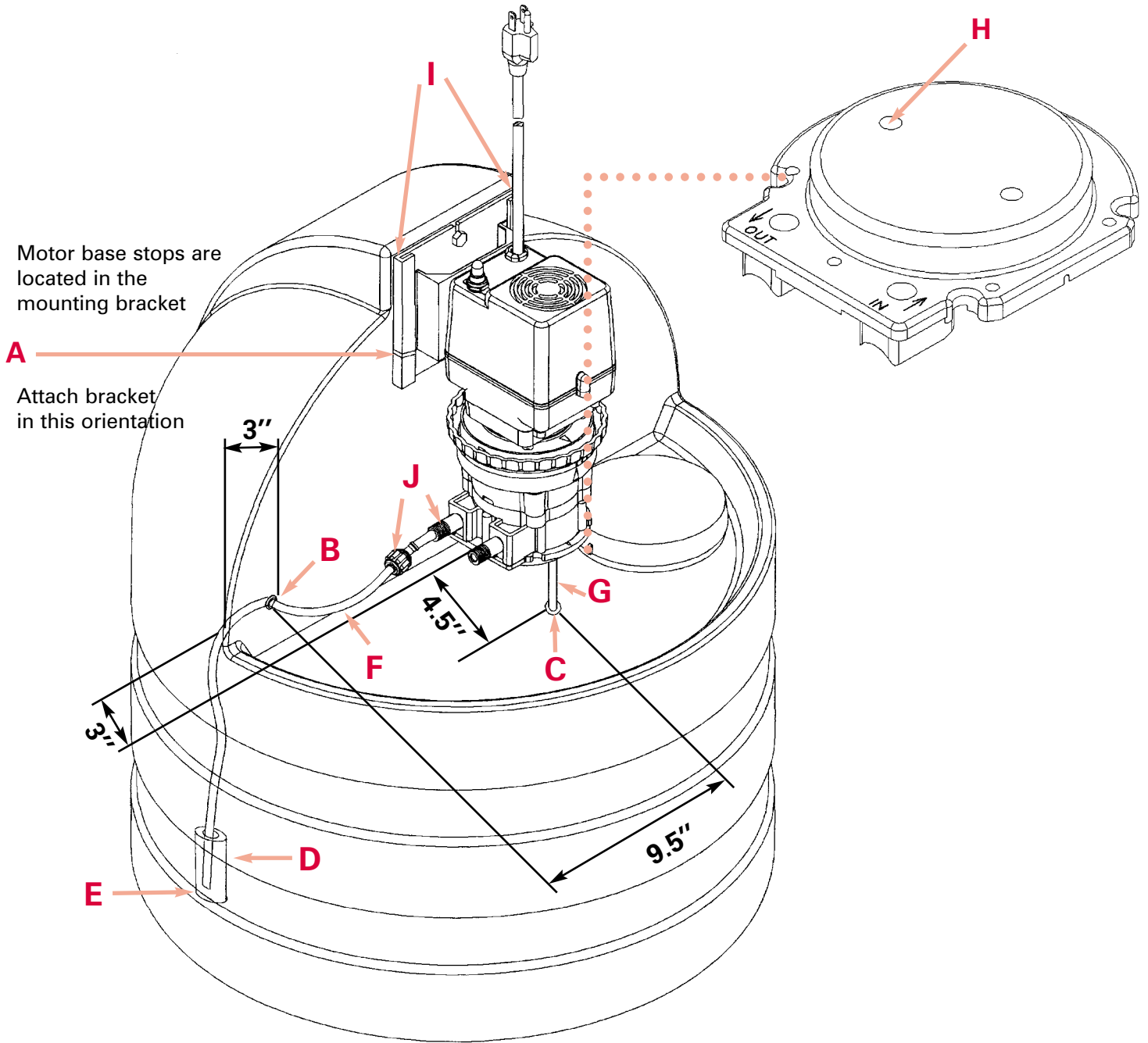

BDF or SVP Pump Motor Base Attachment

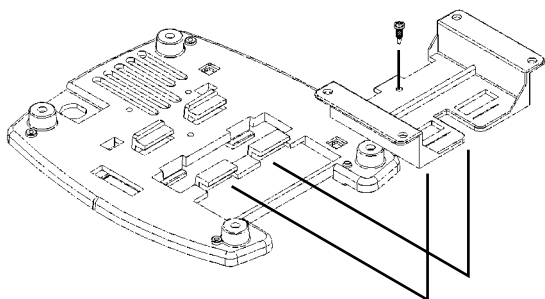

- Align motor base to the bottom of pump motor and slide to the rear of the motor so the base slides under and locks into the tabs.
- Place motor base screw in hole and tighten screw (10 inch lbs) to secure base to pump motor.